

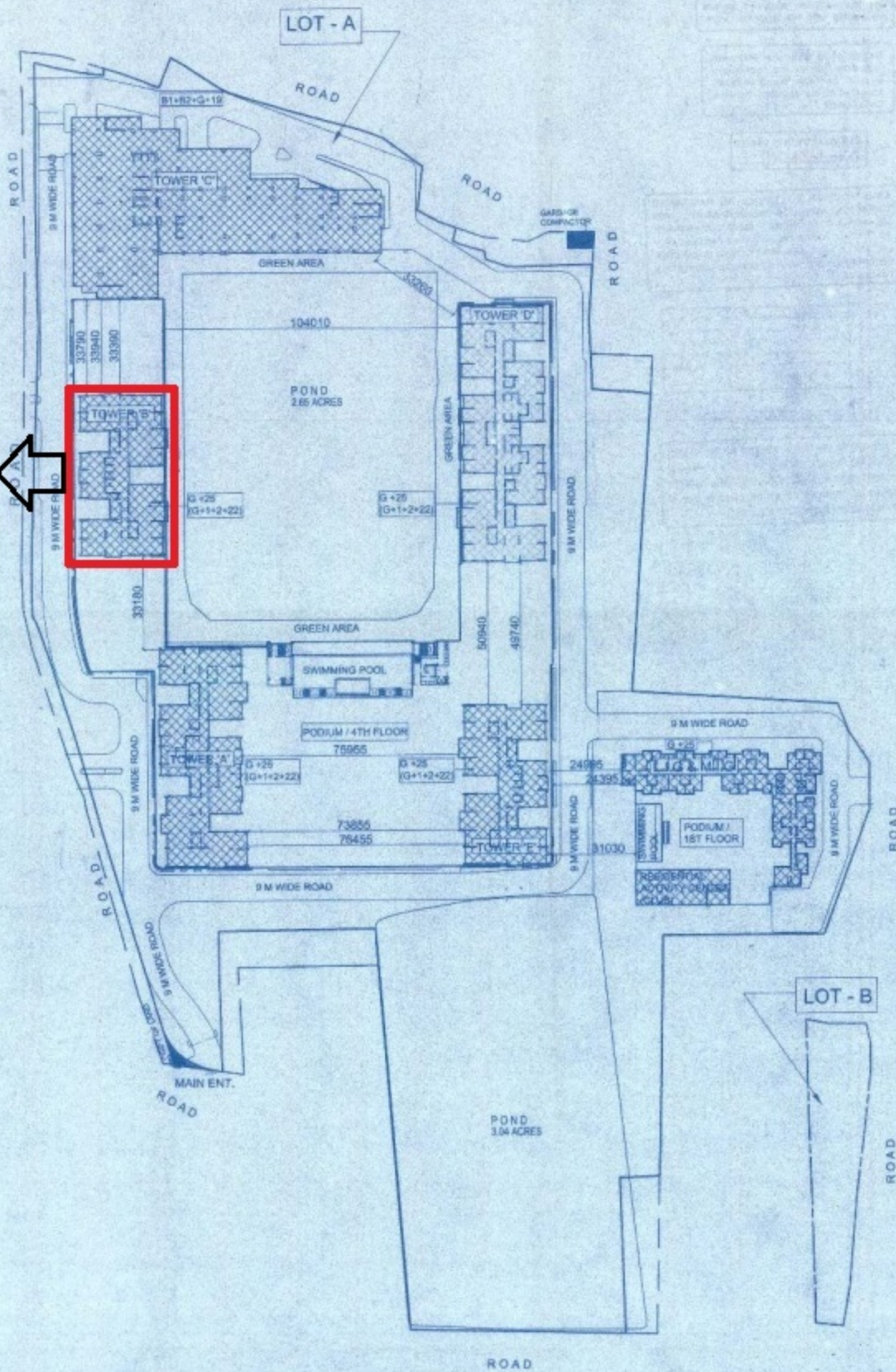

LUXURY PHASE - III



NOTE:
 ALL DIMENSIONS ARE TO FACE UNLESS OTHERWISE SPECIFIED.
 ALL EXTERIOR WALLS ARE TO BE 200 MM THICK AND TO BE CONSTRUCTED IN ACCORDANCE WITH THE REQUIREMENTS OF THE BUILDING REGULATIONS, WEST BENGAL, 1956.
 THE ARCHITECT HAS TO BE RESPONSIBLE FOR THE DESIGN AND CONSTRUCTION OF THE BUILDING AND TO OBTAIN THE NECESSARY APPROVALS FROM THE CONCERNED AUTHORITIES.
 THE ARCHITECT HAS TO BE RESPONSIBLE FOR THE DESIGN AND CONSTRUCTION OF THE BUILDING AND TO OBTAIN THE NECESSARY APPROVALS FROM THE CONCERNED AUTHORITIES.

SIGNATURE OF ARCHITECT
 S. K. BANERJEE
 Architect
 No. - 5/10/3/14/200

DECLARATION OF E.S.E.
 I, the undersigned, being a duly qualified and registered Structural Engineer, do hereby declare that the structural design and construction of the building shown in the above plan is in accordance with the provisions of the Building Regulations, West Bengal, 1956, and the approved drawings of the building.

SIGNATURE OF STRUCTURAL ENGINEER
 S. K. BANERJEE
 Structural Engineer
 No. - 5/10/3/14/200

SIGNATURE OF ARCHITECTURAL ENGINEER
 S. K. BANERJEE
 Architectural Engineer
 No. - 5/10/3/14/200

SIGNATURE OF OWNER
 WEST BENGAL HOUSING BOARD

PROPOSED RESIDENTIAL COMPLEX AT 405, BARAKHOLA, DAG NO- 135(P), 136(P), 137(F), 128/165(P), 127/169(P), 129/170(P), 129/171(P) & 124/167(P) IN MOUZA-BARAKHOLA, J.L. NO. 21 P. S. - PURBA JADAVPUR, DIST. - 24-PGS. (SOUTH), MUKUNDAPUR KMC WARD NO- 109, BOROUGH NO. XII, KOL- 700099.

WEST BENGAL HOUSING BOARD

BLOCK LAYOUT OF MASTER PLAN
 SUKANYA & ASSOCIATES
 110, 2ND FLOOR, 11, COLLEGE ROAD, KOLKATA - 700016

SCALE: 1 CM = 10 METERS	DATE: 14/11/11
PROJECT NO: 20/11/34(10)	REVISION: 01
DATE: 14/11/11	BY: S. K. BANERJEE
DATE: 14/11/11	BY: S. K. BANERJEE